

CDO-100 1ph & 3ph Flangemount Operator

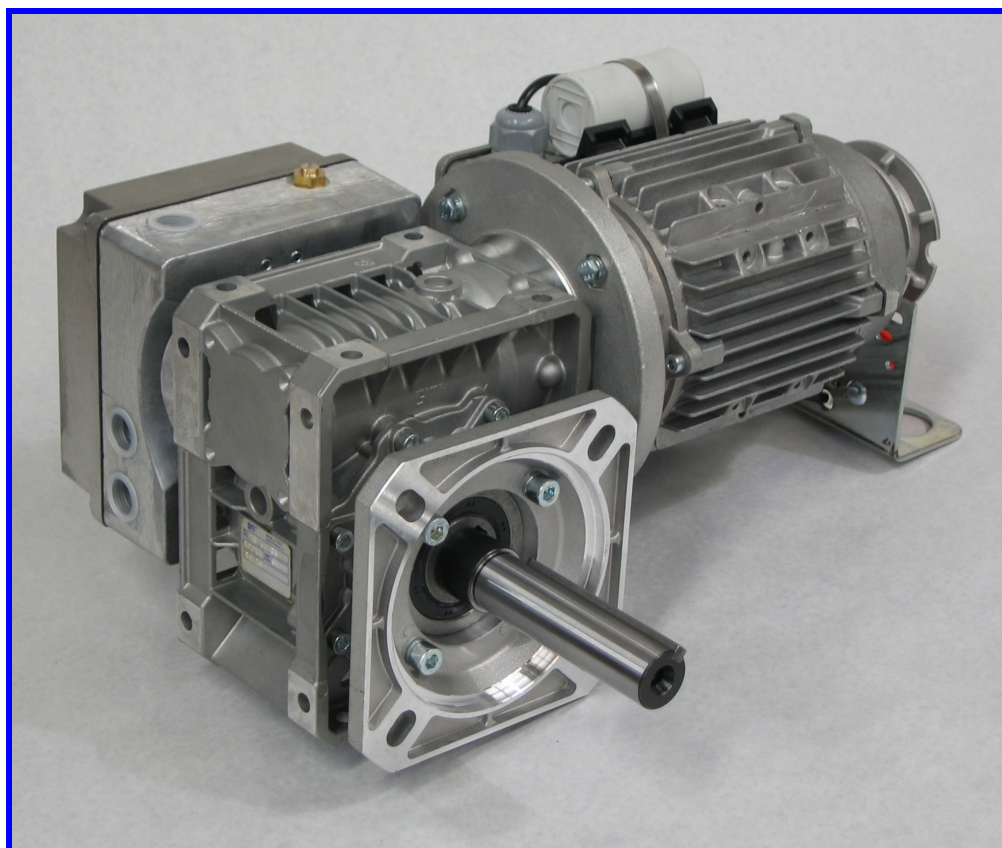

Special Features:

- * Available with pre-wired starter
- * Safety Interlock Switch for manual operation
- * Integral Thermal Protection
- * 1" industry standard output shaft
- * IP 54 Environment Protection
- * Gear driven Limit Switches
- * Phosphor bronze Worm Wheel
- * Handing can be changed on site to suit the installation
- * Available with a variety of manual operating systems
- * Developed to make installation easy and simple

Please Contact Our Sales Department On 01928 579050 For Further Information

Product Description

The CDO-100 rolling door flangemount operator has a 0.37kW single phase or 0.75kW three phase motor.

These models are available with hand crank, floor level hand chain & high level hand chain systems which enable the roller shutter door to be manually opened & closed when required.

TECHNICAL INFORMATION

Data \ Type	CDO-100 c/w Hand Crank	CDO-100 c/w Floor Level Hand Chain	CDO-100 c/w High Level hand Chain
<i>Power (kW)</i>	0.37 (1ph) or 0.75 (3ph)		
<i>Torque (Nm)</i>	90 (1ph) or 135 (3ph)		
<i>Output Speed (R.P.M.)</i>	24		
<i>Number of Turns</i>	40		
<i>IP Rating</i>	I.P.54		
<i>Current (Amps)</i>	2.57 (1ph) or 1.85 (3ph)		
<i>Power Supply</i>	230v / 1ph / 50Hz or 400v / 3ph / 50Hz		

DIMENSIONS: CDO-100 1ph c/w High Level Hand Chain

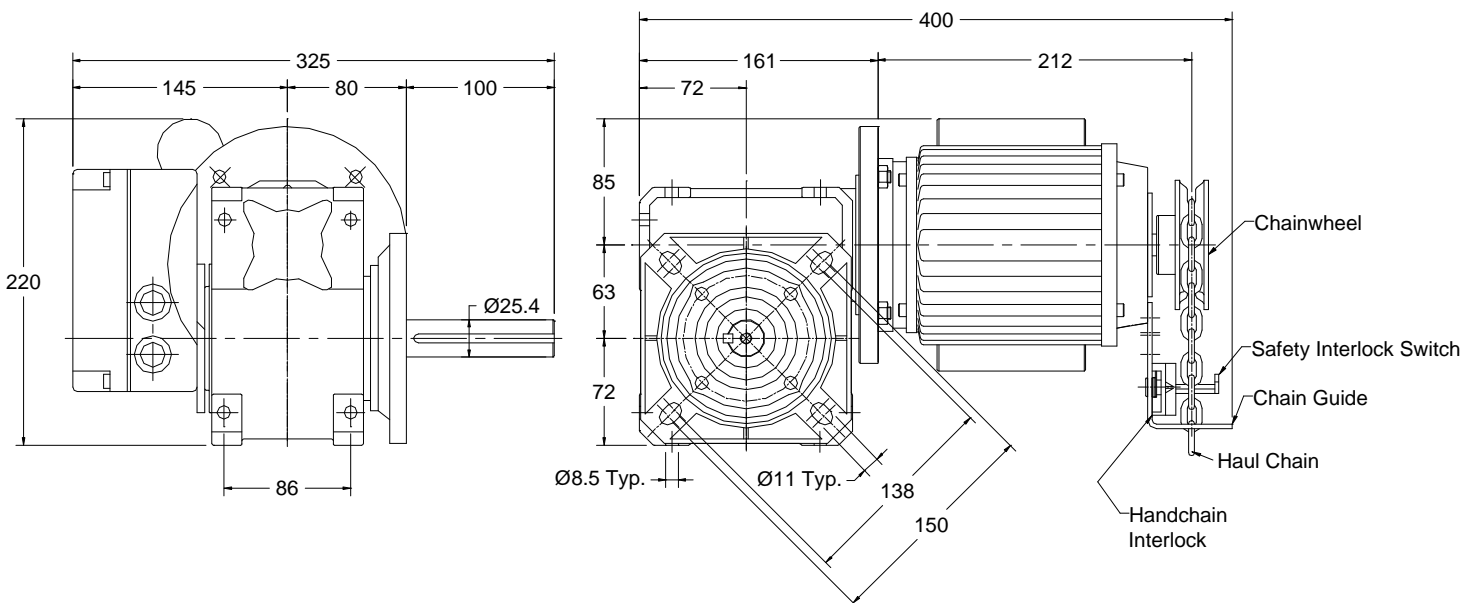

Please Contact Our Sales Department On 01928 579050 For Further Information