

## Certified Compliance for Spring Assisted Shutters CDO-100 KV1 Operator

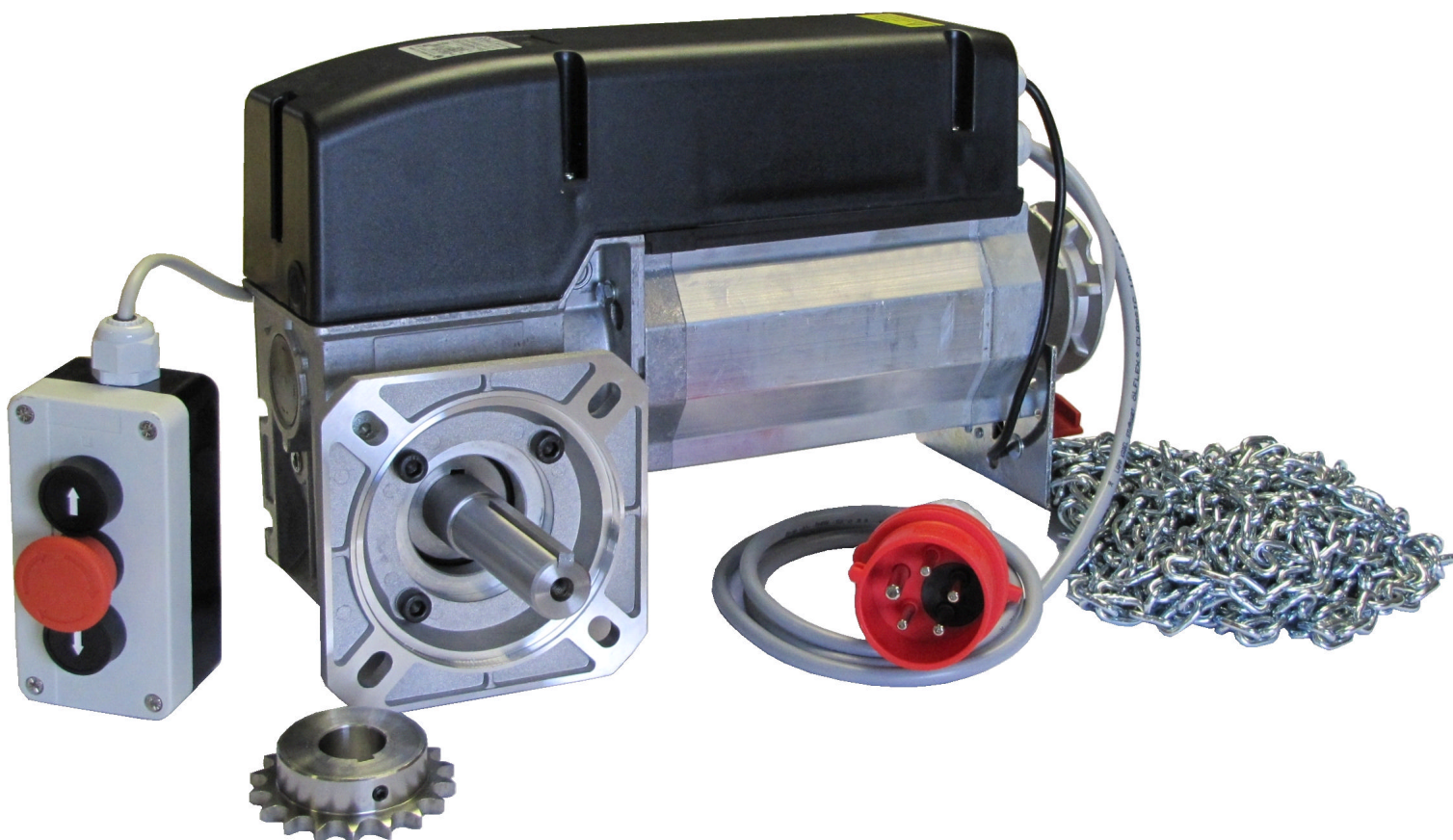

### Special Features:

- Automatic load sensing and self learning function will detect spring failures / spring wear or obstructions.
- Pre-wired for easy installation, unit can be handed on site.
- 1" industry standard output shaft.
- Integral thermal protection with IP54 enclosure.
- Multifunction control board with:
  - \* Auto close.
  - \* Adjustable timed return.
  - \* Go function for radio and loop
  - \* Pneumatic or conductive monitored safety edge.
  - \* 24v control circuit.

Please Contact Our Sales Department On 01928 579050 For Further Information

## Product Description

The CDO-100KV1 Spring Sensor Door Operator has a 0.55kW, 400V Three Phase Motor. This model is available with Hand Crank, Floor Level Hand Chain & High Level Hand Chain Systems, which enables the roller shutter door to be manually opened & closed when required.

### TECHNICAL INFORMATION

Data \ Type	CDO-100KV1 Spring Sensor
<i>Power (kW)</i>	0.55
<i>Torque (Nm)</i>	100
<i>Output Speed (R.P.M.)</i>	30
<i>IP Rating</i>	54
<i>Current (Amps)</i>	1.8
<i>Power Supply</i>	400V / 3ph / 50Hz

### DIMENSIONS: CDO-100KV1 Spring Sensor 3ph c/w High Level Hand Chain

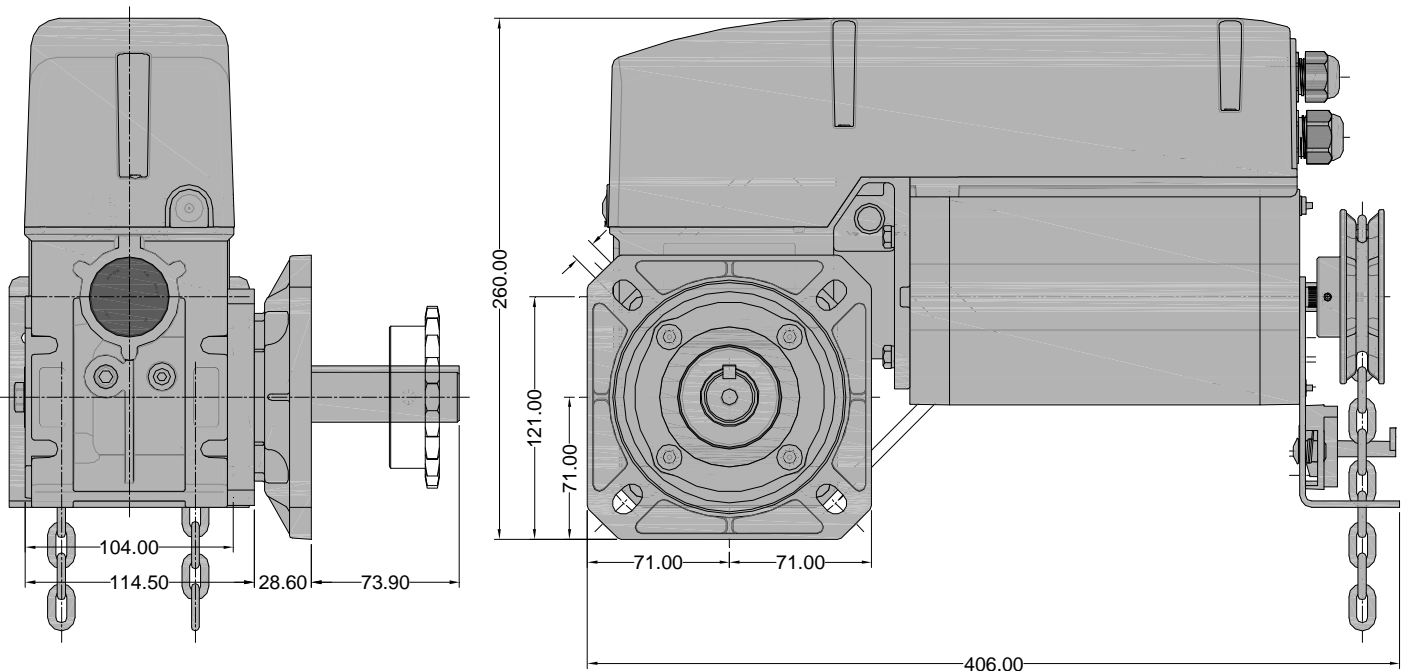

Please Contact Our Sales Department On 01928 579050 For Further Information